

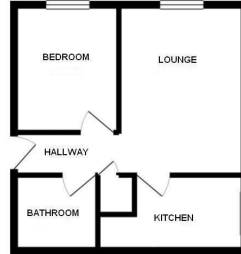

Bedford Road, Sandy

£725

- One Bedroom First Floor flat
- Deposit £801
- Council Tax: A
- Close to town Centre
- Deposit free option available - Flatfair
- Available May
- Allocated parking space
- EPC: D



Viewings

PLEASE REQUEST APPLICATION FORM TO
BE CONSIDERED TO VIEW

Council Tax Band

A
EPC Rating:
D

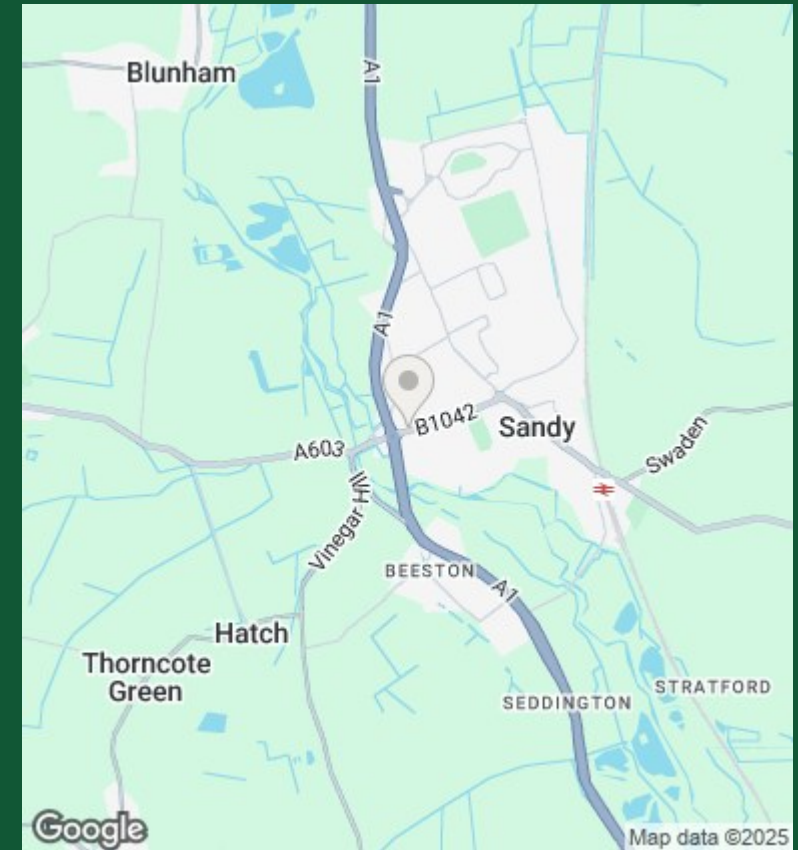

Energy Efficiency Rating		
	Current	Potential
Very energy efficient - lower running costs		
(92 plus) A		
(81-91) B		
(69-80) C		
(55-68) D	67	
(39-54) E		
(21-38) F		
(1-20) G		
Not energy efficient - higher running costs		
England & Wales		EU Directive 2002/91/EC