



18b Longfield Road, Sandy, SG19 1LJ

Price Guide £150,000

- CHAIN FREE
- Ground Floor
- Long Lease
- Secure Gated Parking
- Good Links to A1, Town Centre and Train Station
- Share of Freehold
- Excellent First time buy
- Small Block
- Refurbishment required

Longfield Road

Approximate Gross Internal Area
611 sq ft - 57 sq m

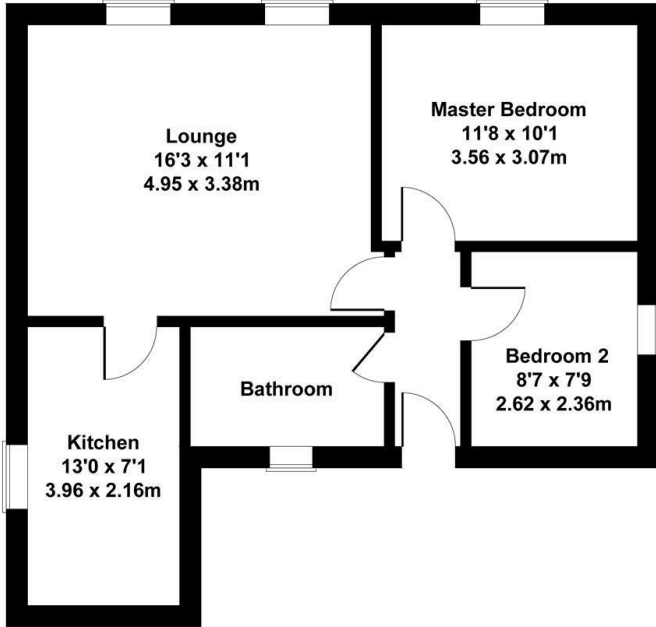

Not to Scale. Produced by The Plan Portal 2024
For Illustrative Purposes Only.

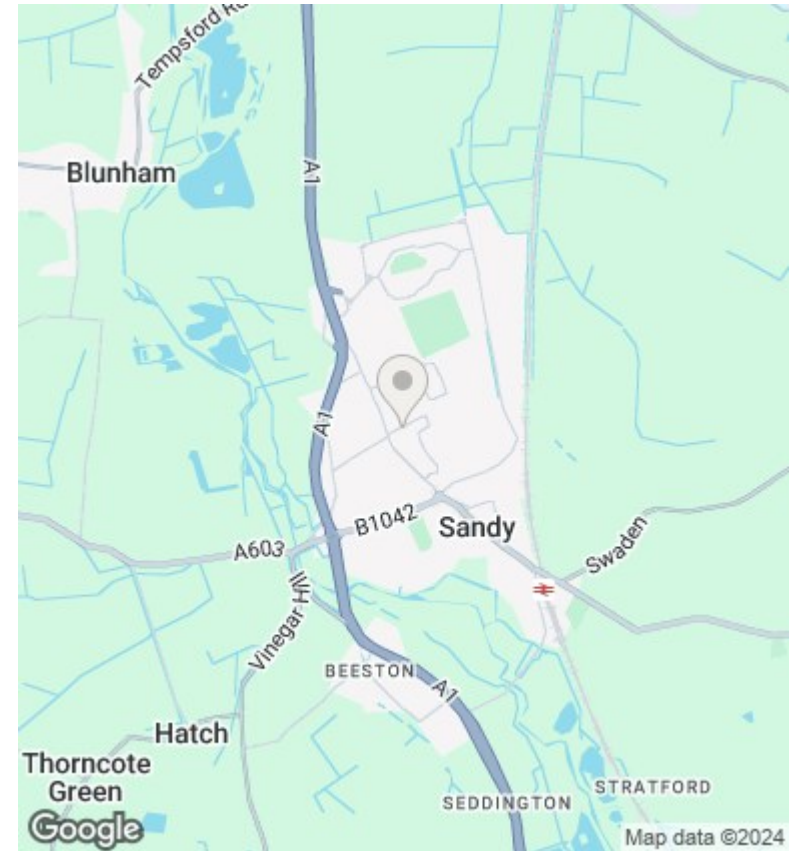

Directions

Viewings

Viewings by arrangement only. Call 01767 691122 to make an appointment.

Council Tax Band

B

EPC Rating:

E

Energy Efficiency Rating		
	Current	Potential
Very energy efficient - lower running costs		
(92 plus) A		
(81-91) B		
(69-80) C		73
(55-68) D		
(39-54) E	49	
(21-38) F		
(1-20) G		
Not energy efficient - higher running costs		
England & Wales	EU Directive 2002/91/EC	