



## 35 Owlswood, Sandy, SG19 2SL

Price Guide £360,000

- 4-Bedroom family home
- Stunning sun-room with vaulted ceiling, skylights and bi-fold doors
- Spacious & re-fitted kitchen/diner
- High energy efficiency rating
- Immaculate presentation
- 3 Double bedrooms with integral wardrobe/storage space
- Cloakroom & Family bathroom
- Open design & highly presented living space
- Contemporary en-suite to master
- Garage & Driveway for off-road parking

## Owlswood, Sandy, SG19 2SL

Approximate Gross Internal Area  
1216 sq ft - 113 sq m

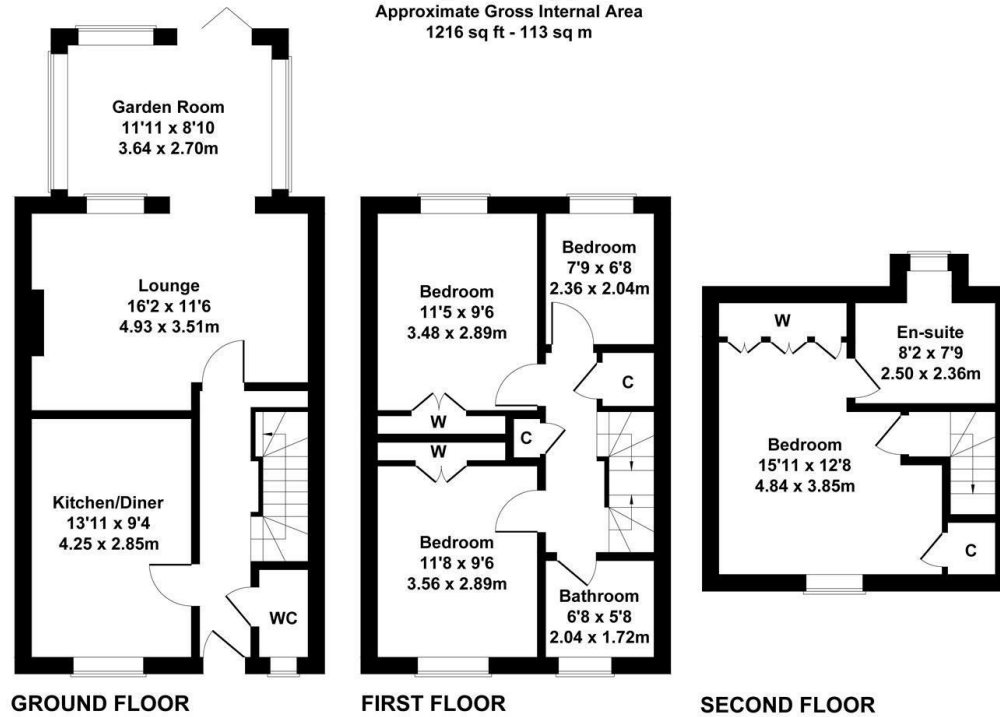

Not to Scale. Produced by The Plan Portal 2023  
For Illustrative Purposes Only.

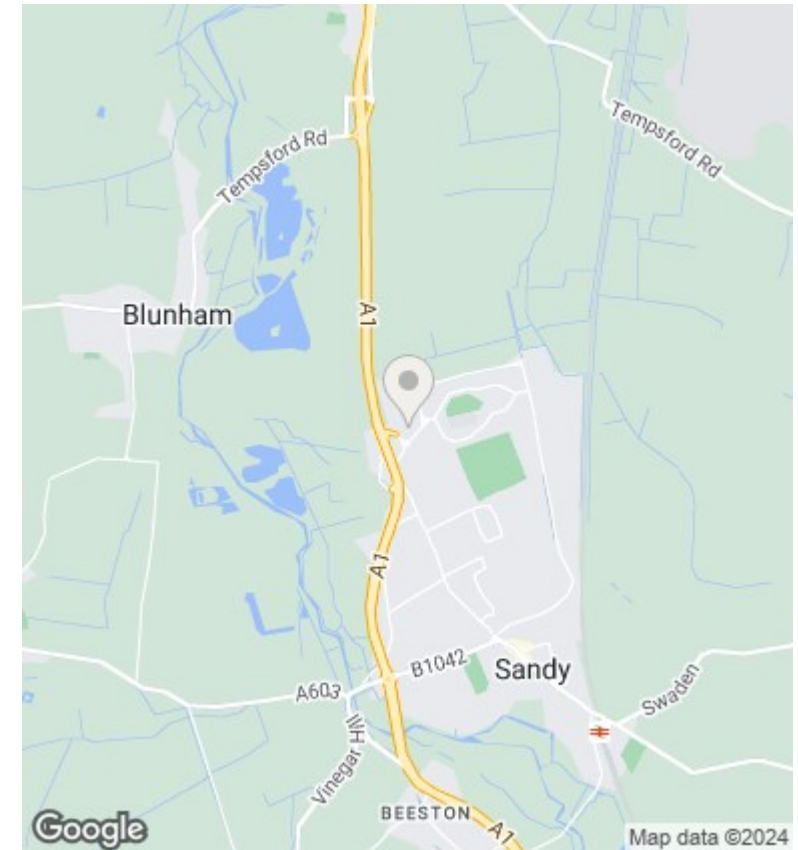

### Directions

### Viewings

Viewings by arrangement only. Call 01767 691122 to make an appointment.

### Council Tax Band

D

### EPC Rating:

C

