



Rowan Court

Sandy, bedfordhsire, SG19 1LF

£210,000

Property Features

- CHAIN FREE
- Popular location
- Viewing Highly Recommended
- Two bedrooms
- Allocated parking spaces
- Enclosed Gardens
- Close proximity to town centre
- cul de sac location
- Excellent first time buy

Full Description

****CHAIN FREE**** Two bedroom cluster home with a private garden and allocated parking situated in a quite cul de sac location. Accommodation comprises of sitting room, fitted kitchen, two bedrooms, bathroom, delightful private garden, allocated parking for one vehicle. situated within close proximity walking distance of the town centre & train station Viewing is highly advised

ENTRANCE HALL

KITCHEN

11' 7" x 6' 7" (3.53m x 2.01m)

LOUNGE

12' 6" x 11' 6" (3.81m x 3.51m)

LANDING

Access to loft space

MASTER BEDROOM

11' 7" x 9' 2" (3.53m x 2.79m)

SHOWER ROOM

GARDEN

Enclosed by timber fence, gated side access, mainly laid to lawn with patio area leading to front door

PARKING

one allocated space





Score	Energy rating	Current	Potential
92+	A		
81-91	B		85 B
69-80	C		
55-68	D	65 D	
39-54	E		
21-38	F		
1-20	G		

Energy efficiency chart

4 Rowan Court

Approximate Gross Internal Area
535 sq ft - 50 sq m

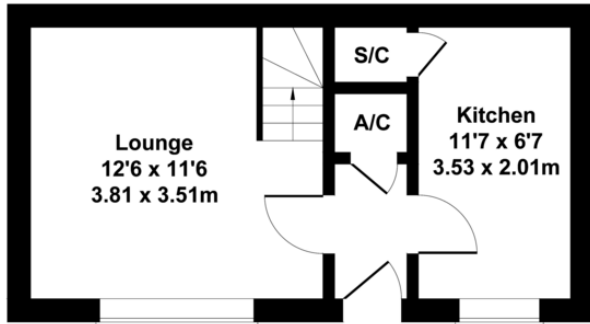

GROUND FLOOR

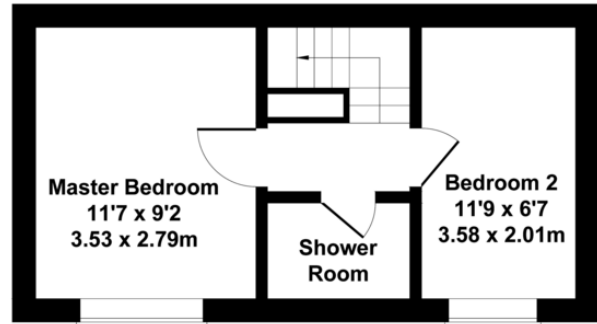

FIRST FLOOR

Not to Scale. Produced by The Plan Portal 2021
For Illustrative Purposes Only.

11 High Street
Sandy
Bedfordshire
SG19 1AG

www.lane-browns.co.uk
sales@lane-browns.co.uk
01767 691122

Agents Note: Whilst every care has been taken to prepare these sales particulars, they are for guidance purposes only. All measurements are approximate and are for general guidance purposes only and whilst every care has been taken to ensure their accuracy, they should not be relied upon and potential buyers are advised to recheck the measurements.