



Rowan Court

Sandy, Bedfordshire SG19 1LF

£200,000

Property Features

- CHAIN FREE
- Two bedrooms
- ideal first time buy
- Enclosed rear garden
- Well presented
- Cul de sac location
- Allocated parking for car
- Close proximity of the Town centre and train station

Full Description

****CHAIN FREE**** Two bedroom cluster home with a private garden and allocated parking situated in a quite cul de sac location. Accommodation comprises of sitting room, fitted kitchen, two bedrooms, bathroom, delightful private garden, allocated parking for one vehicle. situated within close proximity walking distance of the town centre & train station Viewing is highly advised

LOUNGE

12' 7" x 11' 6" (3.84m x 3.51m)

KITCHEN

11' 7" x 6' 6" (3.53m x 1.98m)

FIRST FLOOR

BEDROOM

11' 7" x 10' 4"max (3.53m x 3.15m)

BEDROOM

12' 4" x 6' 7" (3.76m x 2.01m)

BATHROOM

EXTERNALLY

GARDEN

Enclosed by timber fence, gated side access, mainly laid to lawn with patio area leading to front door

PARKING

one allocated space





Score	Energy rating	Current	Potential
92+	A		
81-91	B		
69-80	C		
55-68	D	61 D	67 D
39-54	E		
21-38	F		
1-20	G		



2 Rowan Court

Approximate Gross Internal Area
535 sq ft - 50 sq m

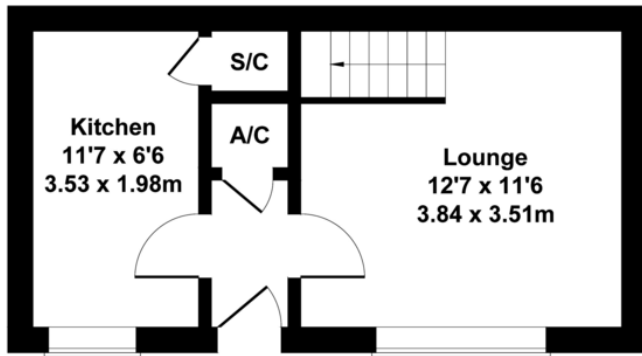

GROUND FLOOR

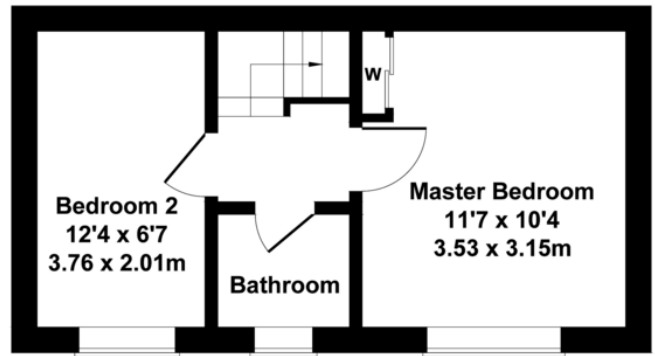

FIRST FLOOR

Not to Scale. Produced by The Plan Portal 2021
For Illustrative Purposes Only.

11 High Street
Sandy
Bedfordshire
SG19 1AG

www.lane-browns.co.uk
sales@lane-browns.co.uk
01767 691122

Agents Note: Whilst every care has been taken to prepare these sales particulars, they are for guidance purposes only. All measurements are approximate are for general guidance purposes only and whilst every care has been taken to ensure their accuracy, they should not be relied upon and potential buyers are advised to recheck the measurements