



Brunel Drive
Biggleswade, SG18 8BH

Guide Price:
£280,000 to £290,000

Property Features

- End of terrace
- Close proximity to Train Station
- Parking for two Cars
- Close proximity to town centre
- WC
- Rear Garden
- Popular family development
- Family Home
- Well Presented
- Cul de sac location

Full Description

****GUIDE PRICE £280,000-£290,000**** This well presented End of terraced Family home situated in the popular market town of Biggleswade, is offered to the market in excellent condition the property is located in a popular development that is with close proximity of both Town center and Train station. The property comprises of entrance hall, kitchen/breakfast room, lounge, three bedrooms and a family bathroom. Externally to the rear there is an enclosed rear garden and further benefits are two allocated parking spaces to the front of the property.

VIEWING IS HIGHLY RECOMMENDED .

ENTRANCE HALL

WC

KITCHEN/BREAKFAST ROOM

11' 7" x 7' 7" (3.53m x 2.31m)

LOUNGE

14' 5" x 13' .7" (4.39m x NaNm)

LANDING

Access to Loft space and airing cupboard

MASTER BEDROOM

12.' 3" x 10' 5" (3.73m x 3.18m)

BEDROOM

8' 8" x 8' 1" (2.64m x 2.46m)

BEDROOM

8' 8" x 6' 1" (2.64m x 1.85m)

BATHROOM



EXTERNALLY

REAR GARDEN

Enclosed by timber fence, gated access mainly laid to lawn with patio area

FRONTAGE

Parking for two cars, shingled area with path to front



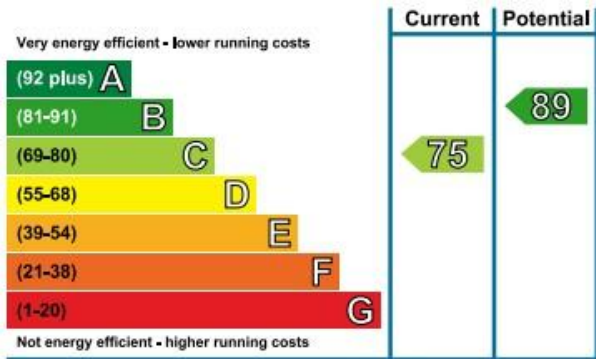

Brunel Drive

Approximate Gross Internal Area
735 sq ft - 68 sq m

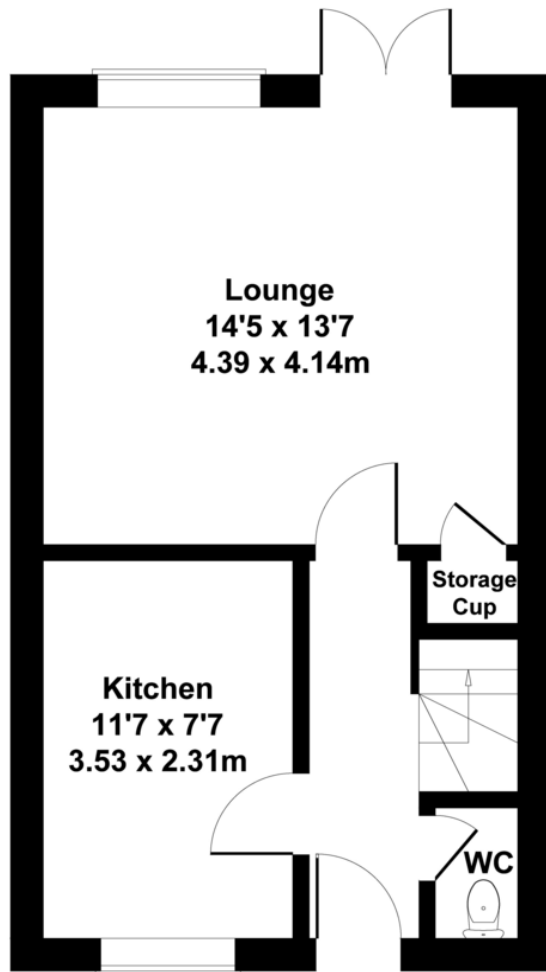

GROUND FLOOR

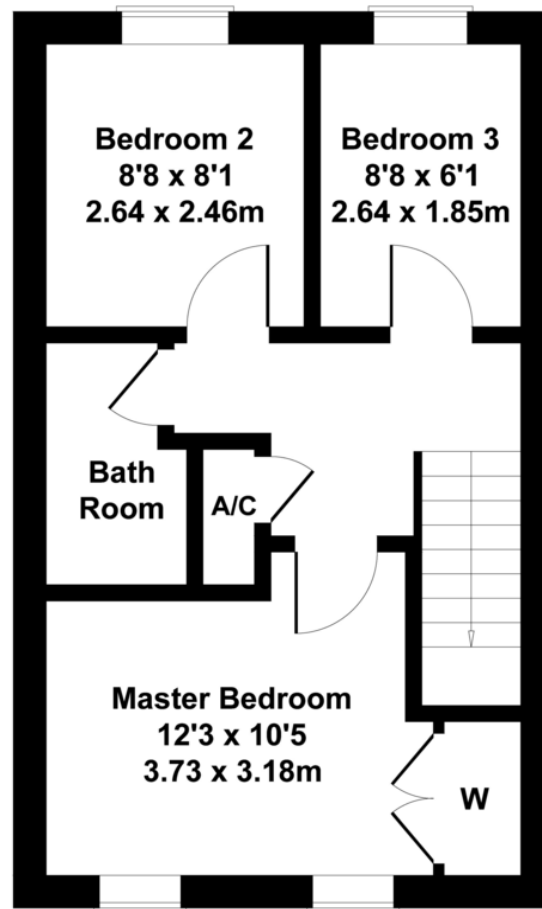

FIRST FLOOR

Not to Scale. Produced by The Plan Portal 2020
For Illustrative Purposes Only.

11 High Street
Sandy
Bedfordshire
SG19 1AG

www.lane-browns.co.uk
james@lane-browns.co.uk
01767 691122

Agents Note: Whilst every care has been taken to prepare these sales particulars, they are for guidance purposes only. All measurements are approximate are for general guidance purposes only and whilst every care has been taken to ensure their accuracy, they should not be relied upon and potential buyers are advised to recheck the measurements